

## 2006 FJR Windshield System Mounting Instructions

### 1. Removing the Yamaha Windshield

- a. Use a 3mm Allen wrench to remove the 2 button head screws holding the Yamaha windshield mask to the windshield. The 2 screws are located under the bottom edge of the windshield mask. See Figure 1.
- b. Remove the mask by pushing it upward and pulling it outward.
- c. Remove the 7 black nylon screws, which hold the windshield to the windshield mount frame. Use a No.1 Phillips screwdriver - the slots in the screws are very shallow. Set the windshield and screws aside.

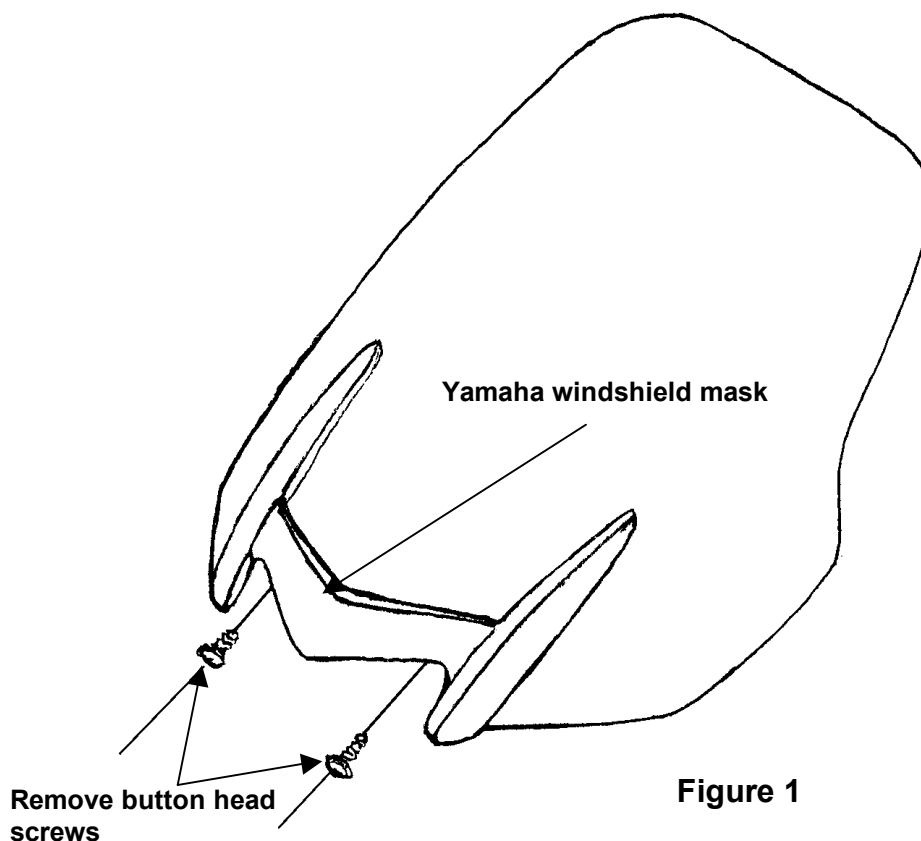

## 2. Mounting the Rifle windshield system

- a. Mount the left Rifle Angle Optimizer onto the left side of the Yamaha windshield mount frame with 3 of the 6 machine screws provided. See Figure 2.
- b. Repeat step a. with the right Angle Optimizer.
- c. If the Rifle Mask Bracket is installed on the inside of the Rifle windshield skip to d.
- d. Install the Rifle Mask Bracket with 2 nylon screws and nuts onto the inside of the Rifle windshield. Cut off the extra length of the screw. The Rifle Mask Bracket holds the Yamaha windshield mask to the windshield (The Rifle windshield has a deeper curve and the Angle Optimizers move the mounting position out to allow for more airflow behind the windshield, the Yamaha windshield mask cannot be reinstalled to the factory windshield mount frame).
- e. Mount the Rifle windshield to the Angle Optimizers with the 6 included nylon windshield screws. Do not over tighten.
- f. Place the Yamaha windshield mask onto the Rifle windshield. Make certain the 4 hooks on the back of the mask are engaged over the edges of the 4 corresponding rectangular holes in the windshield. Then, pull the mask downward and, while maintaining light down force on the mask install the 2 Yamaha button head screws at the bottom of the mask. Lightly tighten the 2 screws.

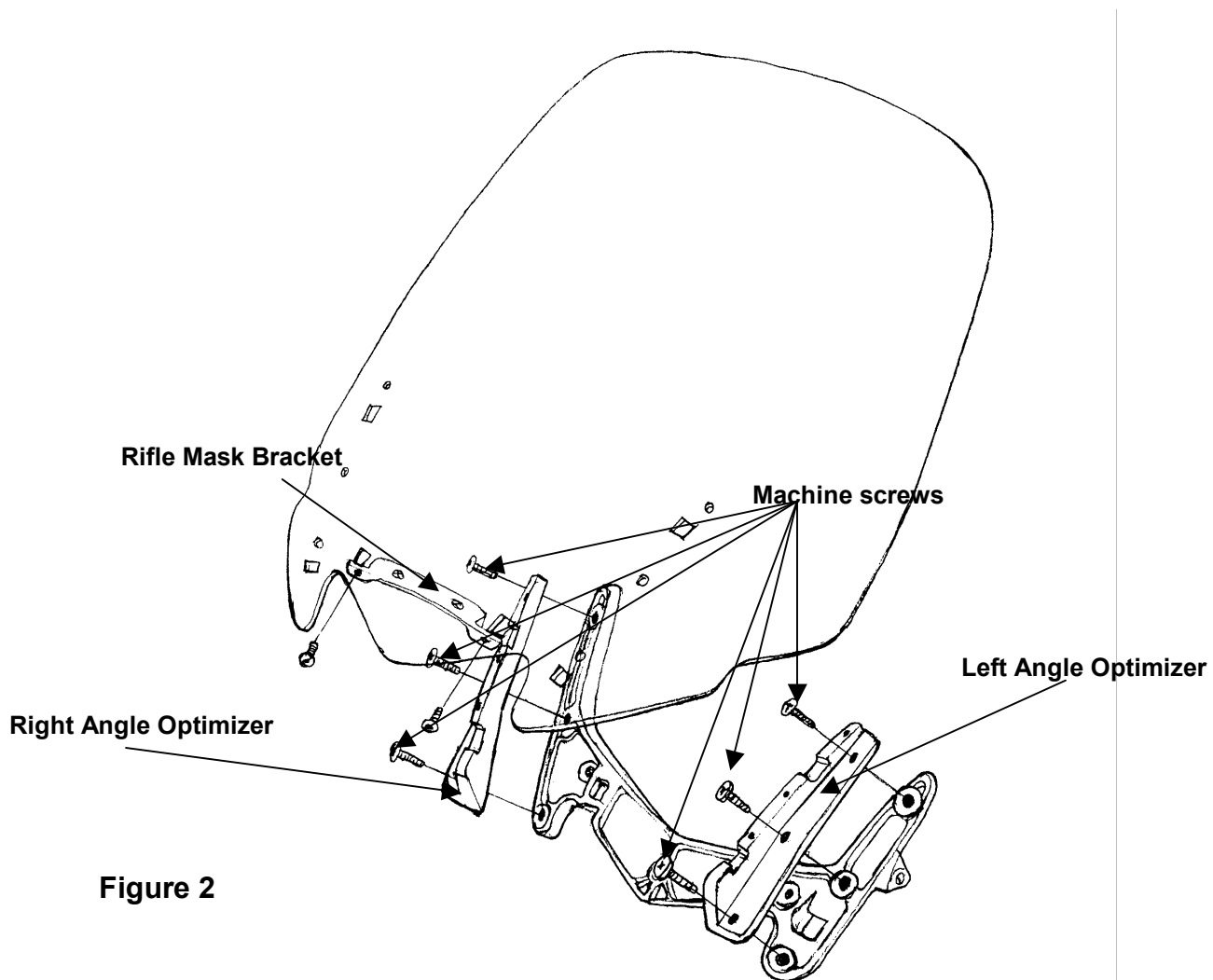

Figure 2